



INSTALLATION GUIDE

ONLINE VIDEO : www.mycartrim.com/installation

IMPORTANT

- ✓ Prior to installation, the vehicle must be warm (above 15° C).
- ✓ Manipulate with care as colored trim have limited flexibility.
- ✓ When washing your vehicle, avoid excessive use of silicon based products as it may infiltrate under the moldings and decrease the adhesion strength.

REQUIRED EQUIPMENT



SPONGE, BUCKET
SOAP AND WATER



MASKING
TAPE



MEASURING
TAPE

SUGGESTED POSITIONNING

This is where your moldings have been designed to be placed. But you can position them where you want. It's a matter of taste!

FRONT:

BACK:

REFERENCE:

1. Clean

The surfaces must be clean and dry. Use a cleaning product compatible with your vehicle.

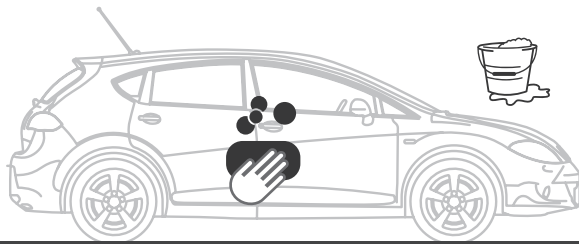

2. Place guide

Use a masking tape to guide yourself and determine desired height and angle before installing the moldings. Measure from provided reference.

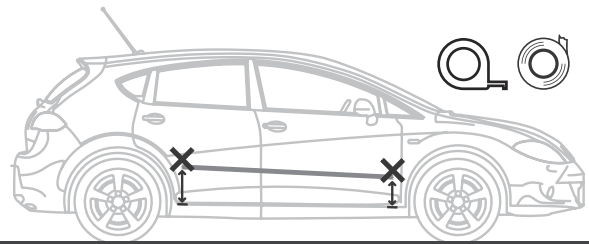

3. Stick

Remove red liner and place the moldings on the vehicle following the guide. Gently stick them on the vehicle to allow repositioning. Once correctly installed, firmly press into position with a clean soft cloth.

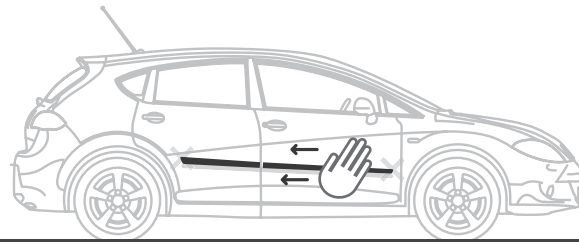

DONE!

If possible leave the vehicle in warm and dry conditions for 24 hours.

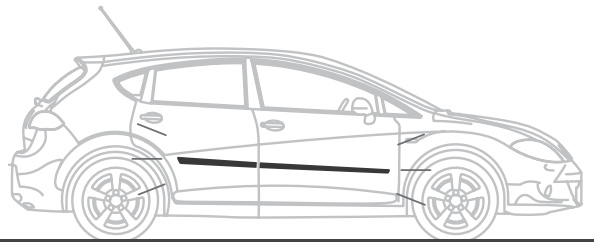

MYCAR TRIM'S TOTAL SATISFACTION GUARANTEE

www.mycartrim.com/warranty



ALL RETURNS ACCEPTED
WITHIN 30 DAYS
OF PURCHASE*

*ON QUALIFIED PRODUCTS



5 YEAR
WARRANTY ON
THE PRODUCT

ANY QUESTIONS ?

support@mycartrim.com

Read our Frequently Asked Questions
www.mycartrim.com/faq

Thanks for choosing MyCar Trim